

Surge arrester

3-electrode arrester

Series/Type: DG3R230L

Customer:

Version/Date: Issue 02/2015-10-8

Surge arrester

3-Electrode arrester

DG3R230L

Features	Applications
<ul style="list-style-type: none"> ● Extremely small size ● Extremely fast response time ● Excellent SMD handling ● Stable performance over life ● Very low capacitance ● High insulation resistance ● RoHS-compatible ● UL-identification, No:E311500 	<ul style="list-style-type: none"> ● Splitter ● PCI Cards ● Morden ● Line cards

Electrical specifications

DC breakdown voltage ^{1) 2)}	230 ±20	V %
Impulse breakdown voltage ¹⁾		
at 100V/us -Typical values of distribution	≤700	
at 1kv/us -Typical values of distribution	≤800	V
Insulation resistance at DC 100V	≥1	GΩ
Capacitance at 1MHz ²⁾	≤1.5	Pf
Service life ³⁾		
10 operations 8/20us	10	KA
1 operation 8/20us	15	KA
1 operation 10/350us	5	KA
1 operation 50Hz(0.8S,9cycles)	50	A
10 operations 50Hz,1S	10	A
300 operations 10/1000us	200	A
Weight	~1.8	g
Storage and operations temperature	-40...+90	°C
Climatic category (GB/T 9043, IEC61643-1)	40/90/21	
Marking,Blue positive	DG3R230L	



Tel: +86-510-81707285
Fax: +86-510-81707277
www.dong-guang.com

DG Elec.

Issue 02/2015-10-8

Please read Cautions and warnings and

important notes at the end of this document.

Surge arrester

3-Electrode arrester

DG3R230L

1) At delivery AQL 0.65 level II ,DIN ISO 2859

2) In ionized mode

3) DC spark-over voltage $\pm 30\%$ after load

Tests according to ITU-T Rec. K. 12 and UL 497B

Terms and current waveforms in accordance with: ITU-T Rec. K. 12; IEC 61643-21 and DIN 57845 / VDE0845

Dimension

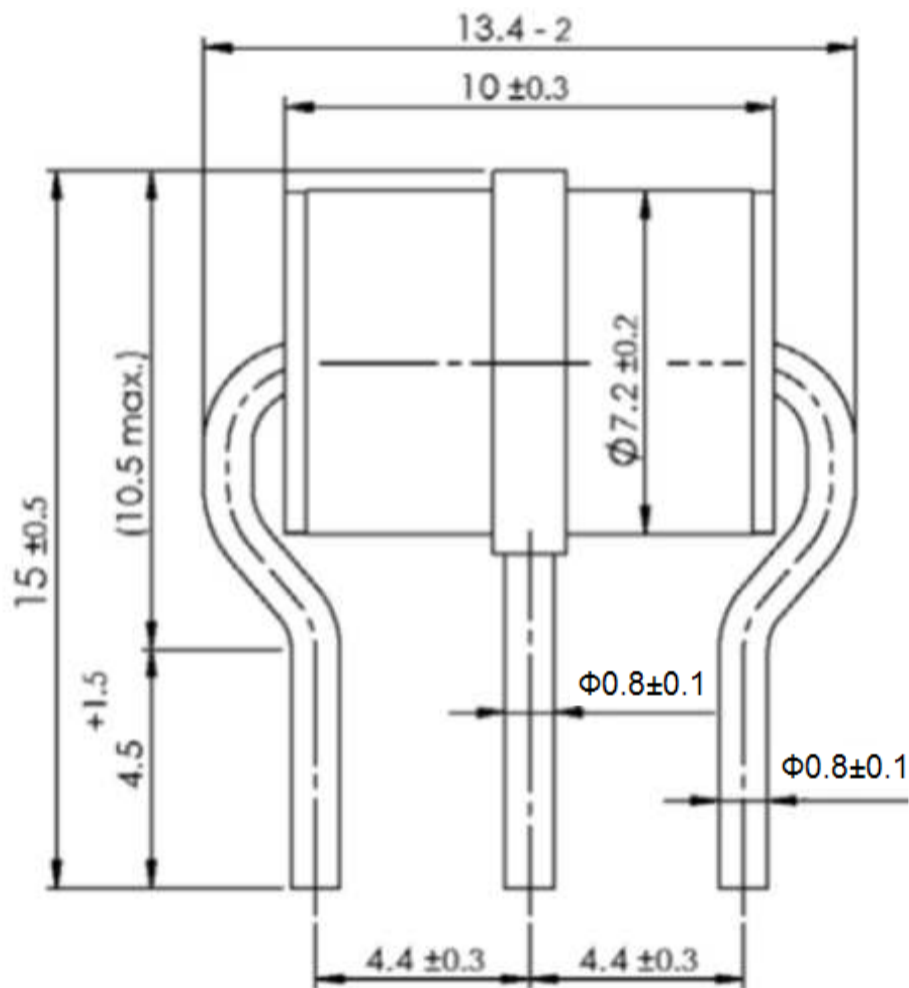

Wire Tin-plated

Dimension in mm

Cautions and warnings

- Depending on the incorporation position, the surge arrester may have to be additionally secured by mechanical means.
- Surge arresters must not be operated directly in power supply networks.
- Surge arresters may become hot in case of longer periods of current stress (danger of burning).
- Damaged surge arresters must not be re-used.